

Instruction Manual

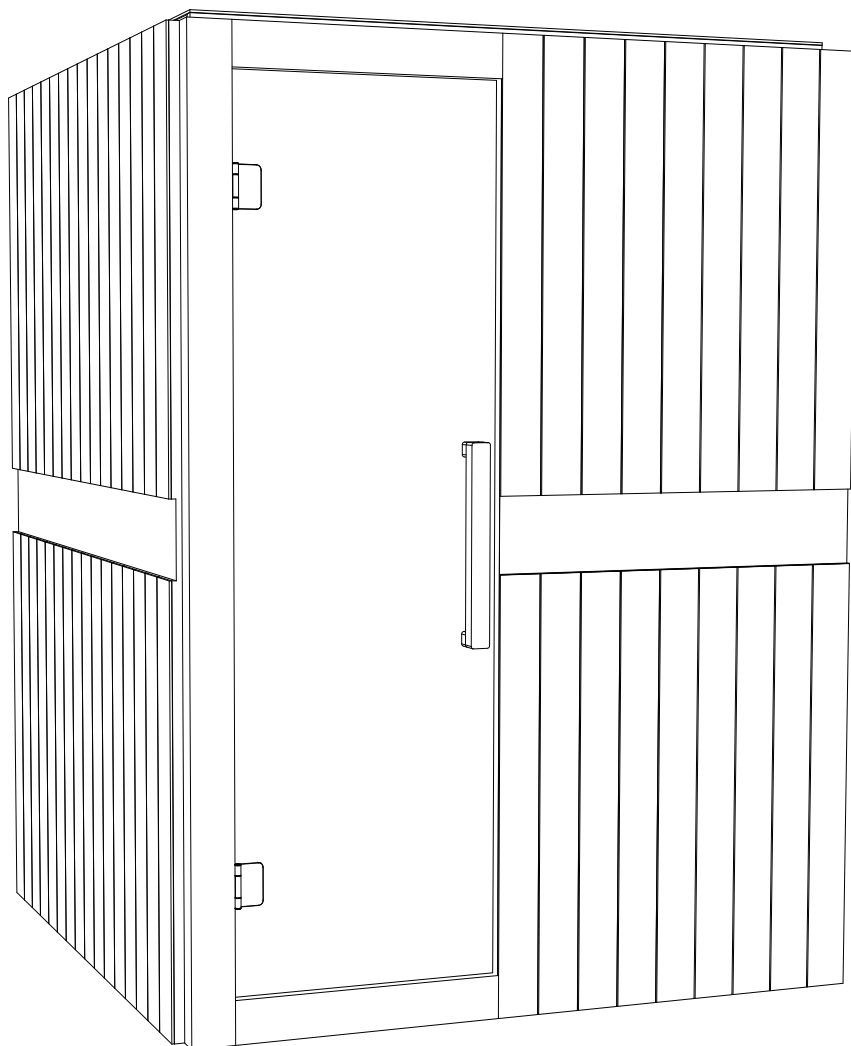

Thank you for choosing our Traditional Sauna!

Due to our continued product improvement, product illustrated on this instruction manual may vary slightly from the actual product.

Import Safety Guides

READ AND FOLLOW ALL INSTRUCTIONS

- A) Extending Socket or other electric appliance is forbidden to be used inside the cabin.
- B) Any lock or latch system must not be fixed to the door of the sauna room, malfunction of which may cause entrapment inside the sauna room.
- C) Open the ventilation window if you feel choking when using sauna room.
- D) Don't use infrared sauna when you are hyperthermia.

The occurrence of hyperthermia: Hyperthermia occurs when the internal temperature of the body reaches a level several degrees above the normal body temperature of 98.6°F (37 °C).

The symptoms of hyperthermia: The symptoms of hyperthermia include an increase in the internal temperature of the body, dizziness, lethargy, drowsiness, and fainting.

The effects of hyperthermia: Failure to perceive heat. Failure to recognize the need to exit the room. Unawareness of impending hazard. Fetal damage to pregnant women. Physical inability to exit the room. Unconsciousness.

WARNING: The use of alcohol, drugs, or medication may lead fatal hyperthermia.

- E) Without authorization from the local electrical inspection institution, any modification to the sauna room is illegal.
- F) Warning: To avoid electric shock or burns, do not operate the sauna room unless heating safety guard is properly installed.
- G) Do not take any flammable materials into sauna room at any time to avoid fire.
- H) Other safety warning:
 - a) Exit immediately when feels uncomfortable, dizzy, or sleepy if stay in the sauna room too long time.
 - b) Supervise children and retarded persons when they are using sauna room at all times.
 - c) Pregnant woman, who in poor health or under medical care should follow the doctor's advice before using the sauna room.
 - d) Using sauna room will cause unconsciousness if over drunk or over taken medicines.
 - e) Please contact maintenance person if sauna room has problems.
 - f) Disconnect sauna room power supply from wall socket before maintaining.

THE MANUAL MUST BE KEPT AVAILABLE FOR FUTURE MAINTENANCE.

Installation

1. Installation requirements

- Do not plug any other appliances into the outlet with your traditional sauna.
- Install the sauna on a completely level floor.
- Do not spray the exterior with water. If the floor is damp, install a floor separator to keep the sauna high & dry.
- Do not store flammable objects or chemical substances near the sauna.
- Similar models also refer to this structure.

Installation procedure

Sauna Room:

1. Structure of Sauna.

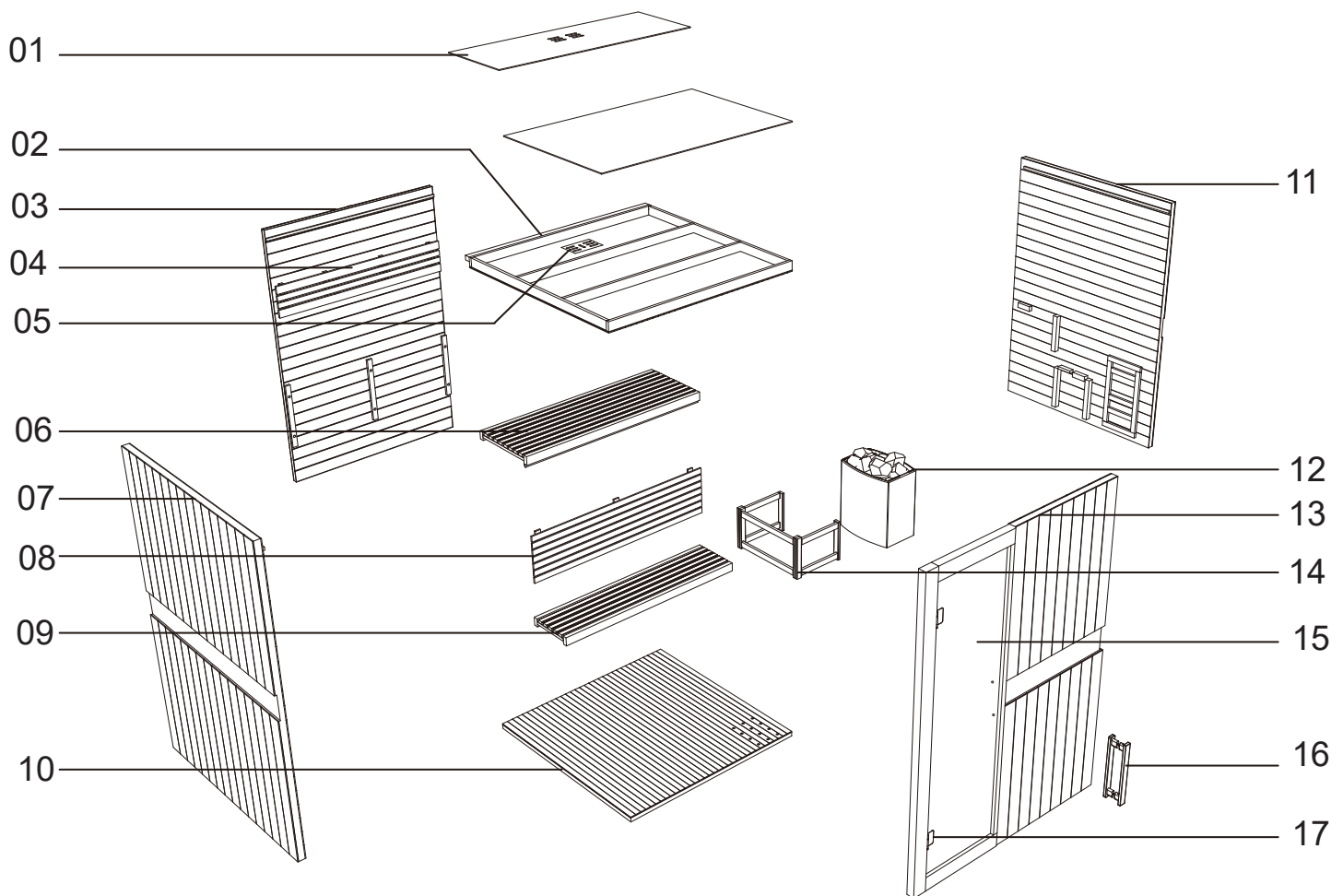

01	Duster cover	06	Bench	11	Right board	16	Handle
02	Top board	07	Left board	12	Sauna stove	17	Hinge
03	Back board	08	Bench front board	13	Front board		
04	Backrest	09	Foot rest board	14	Heater wooden frame		
05	Ventilation	10	Bottom board	15	Glass door		

* The structure may vary from different models. Due to our continued product improvement, product illustrated on this instruction manual may vary slightly from the actual product.

Installation procedure

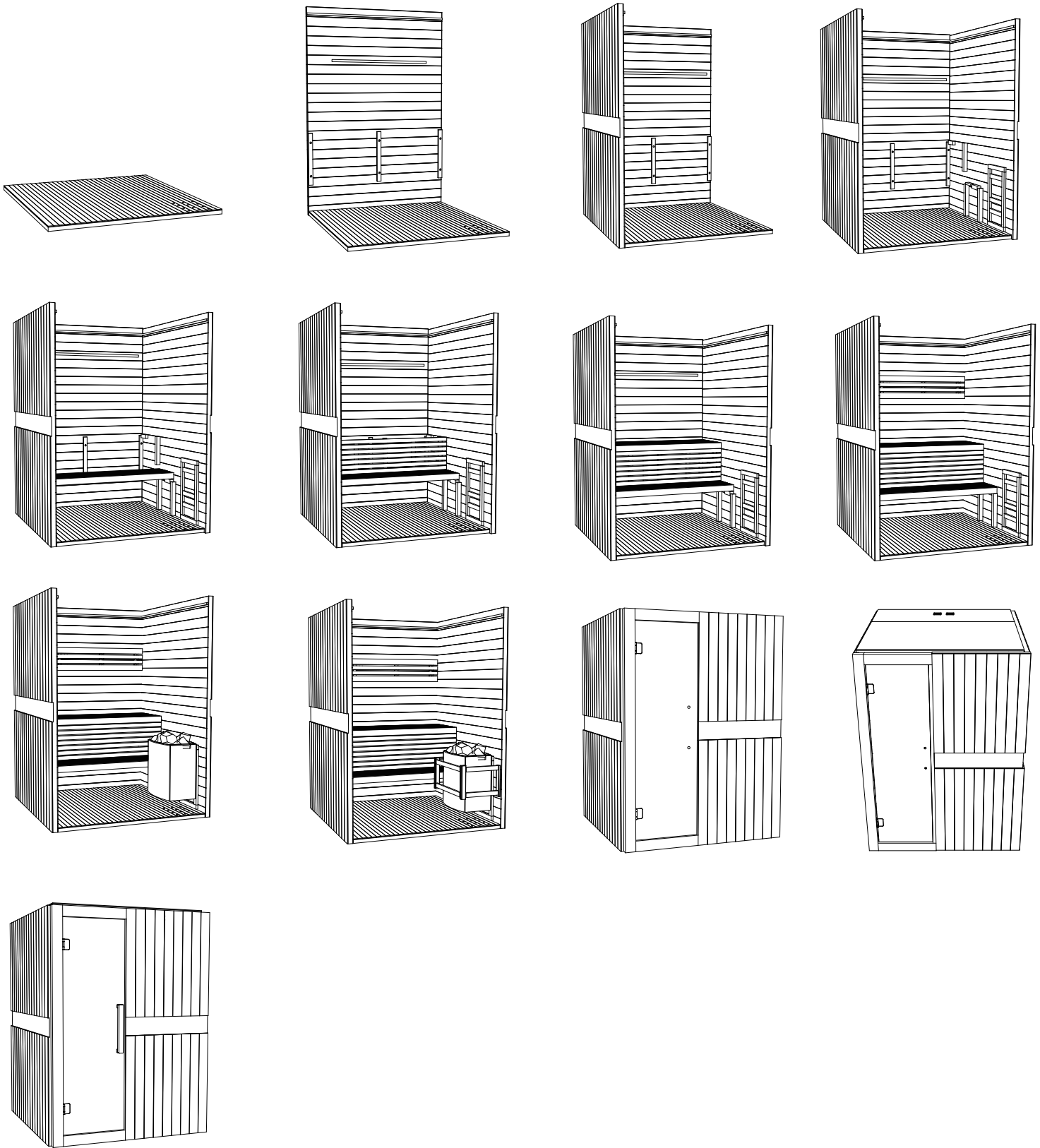

* The structure may vary from different models. Due to our continued product improvement, product illustrated on this instruction manual may vary slightly from the actual product.

Installation of bench and bench support

Put the small bench on the lower support frame

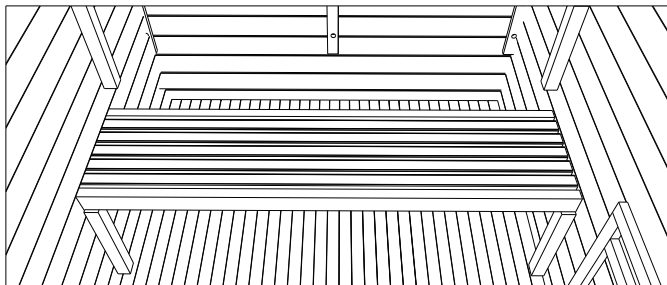
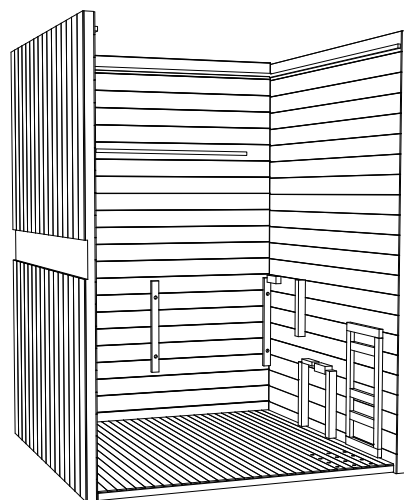
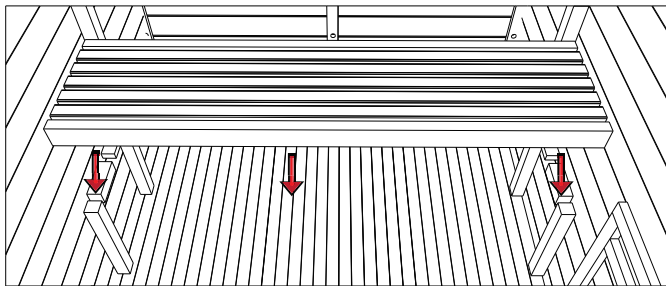

Put the bench support on the small bench

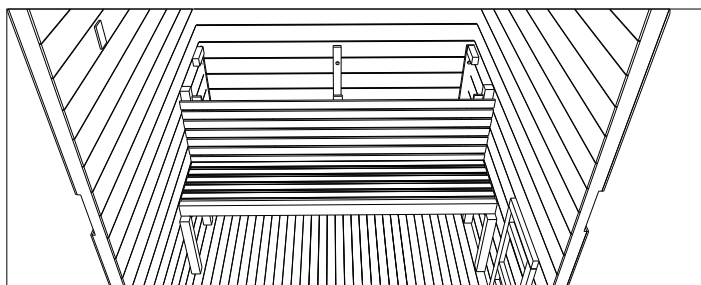
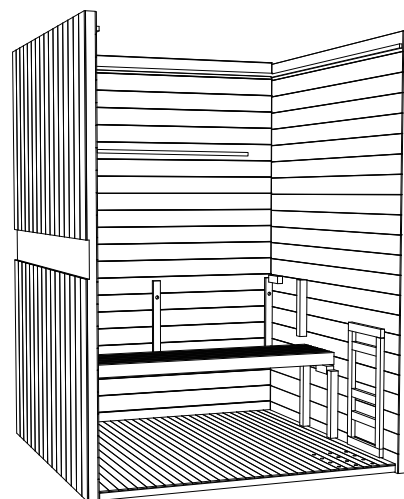
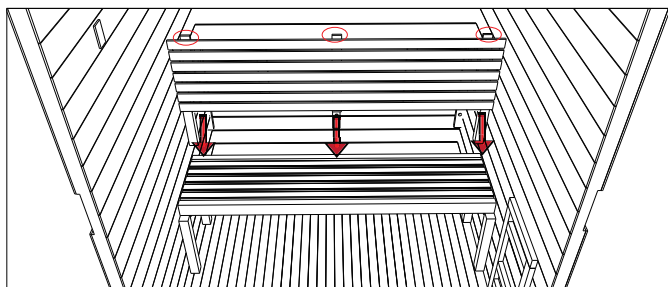

Put the big bench on the bench support

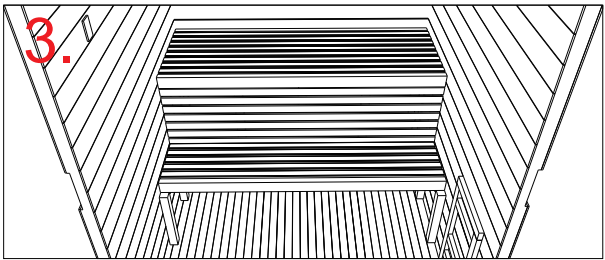
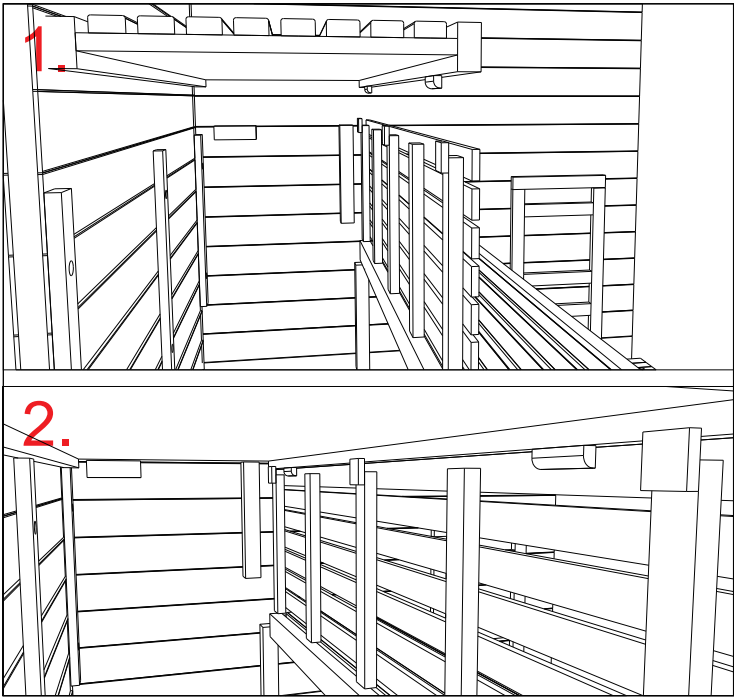
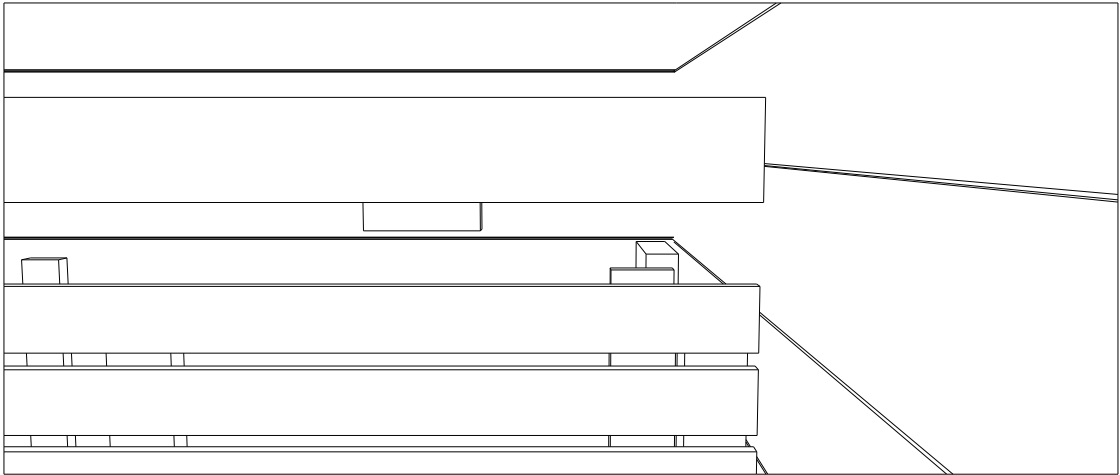
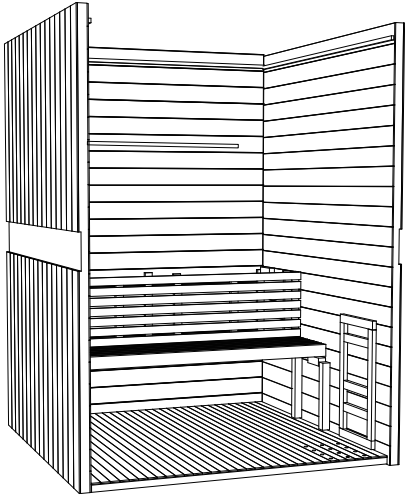
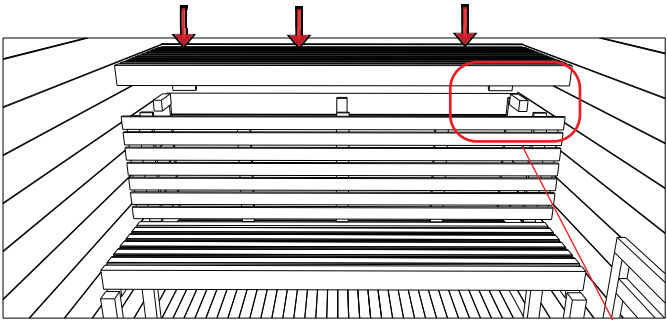

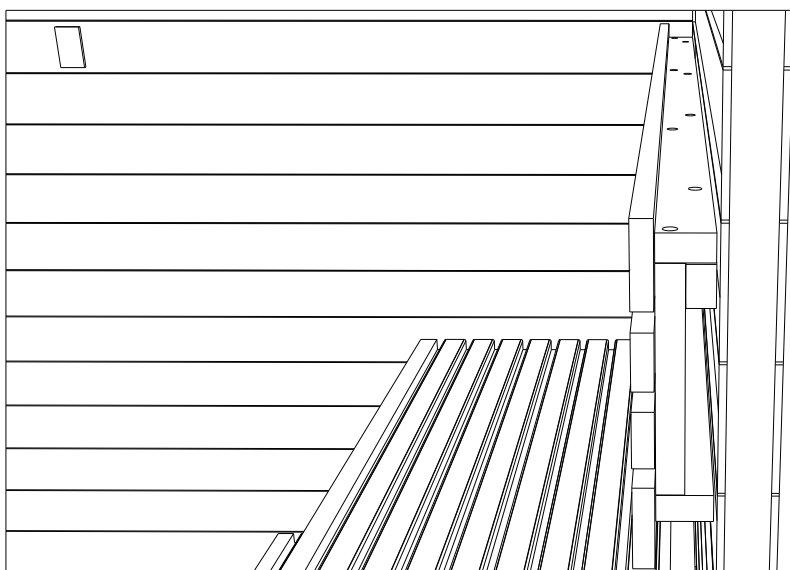
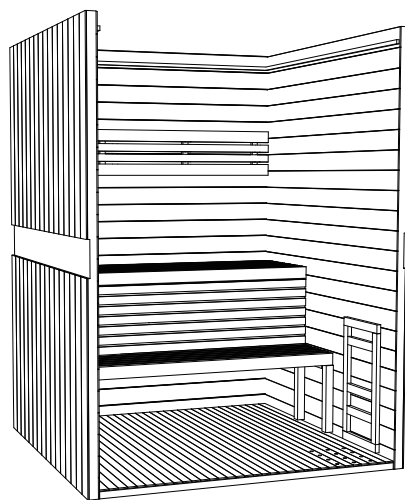
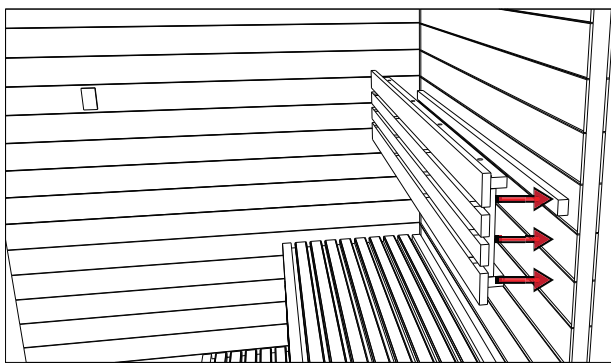

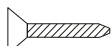
 Ø 4 x 30 4PCS

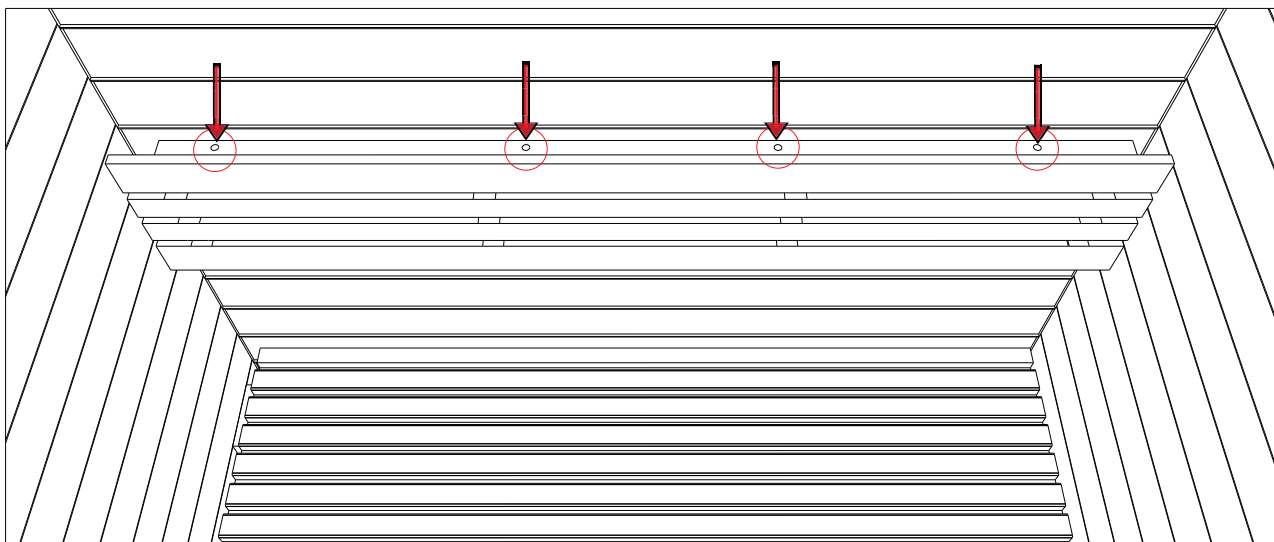

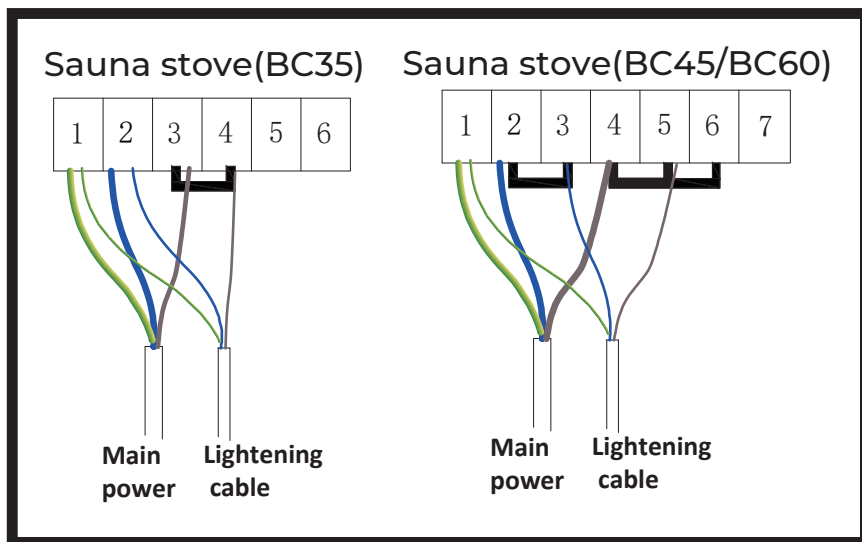
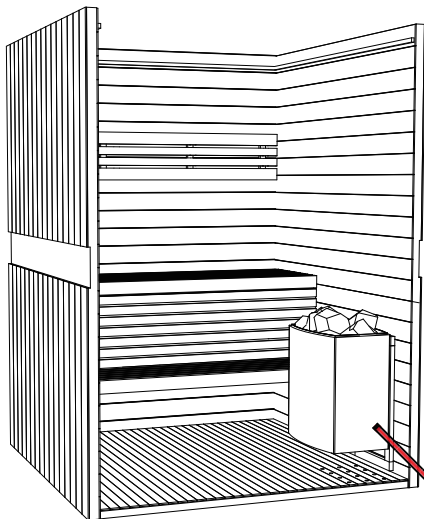

Installation diagram of sauna stove

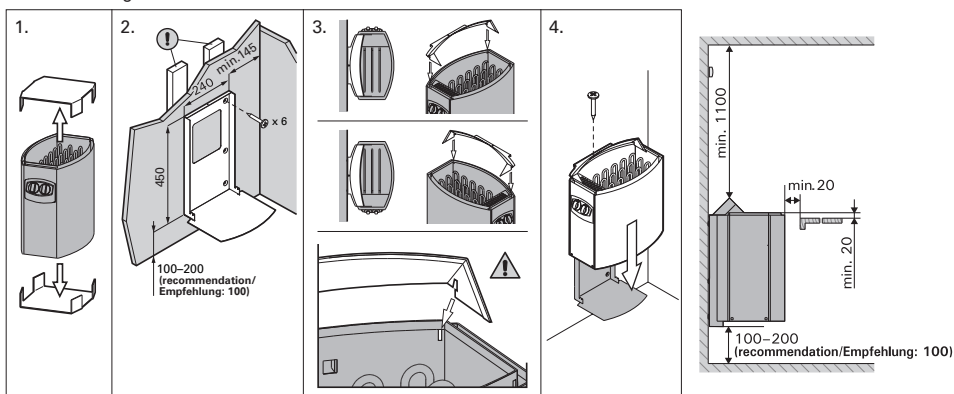

Note: the sauna stove and wooden frame shall be subject to the actual object.
Please refer to the manual of sauna stove for installation.
For the use and precautions of the sauna stove, please refer to the instructions
provided with the sauna stove!

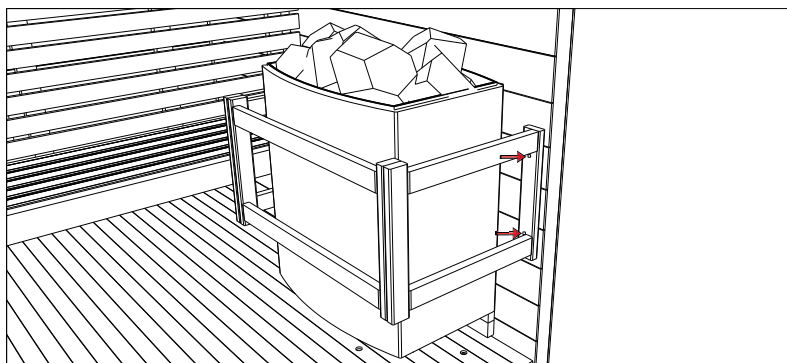
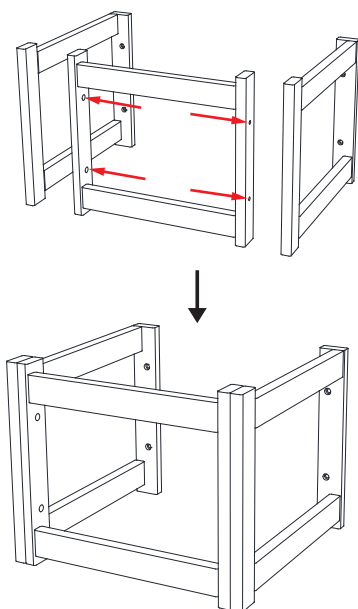
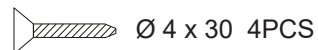
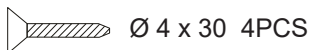

Install the sauna stove protection frame

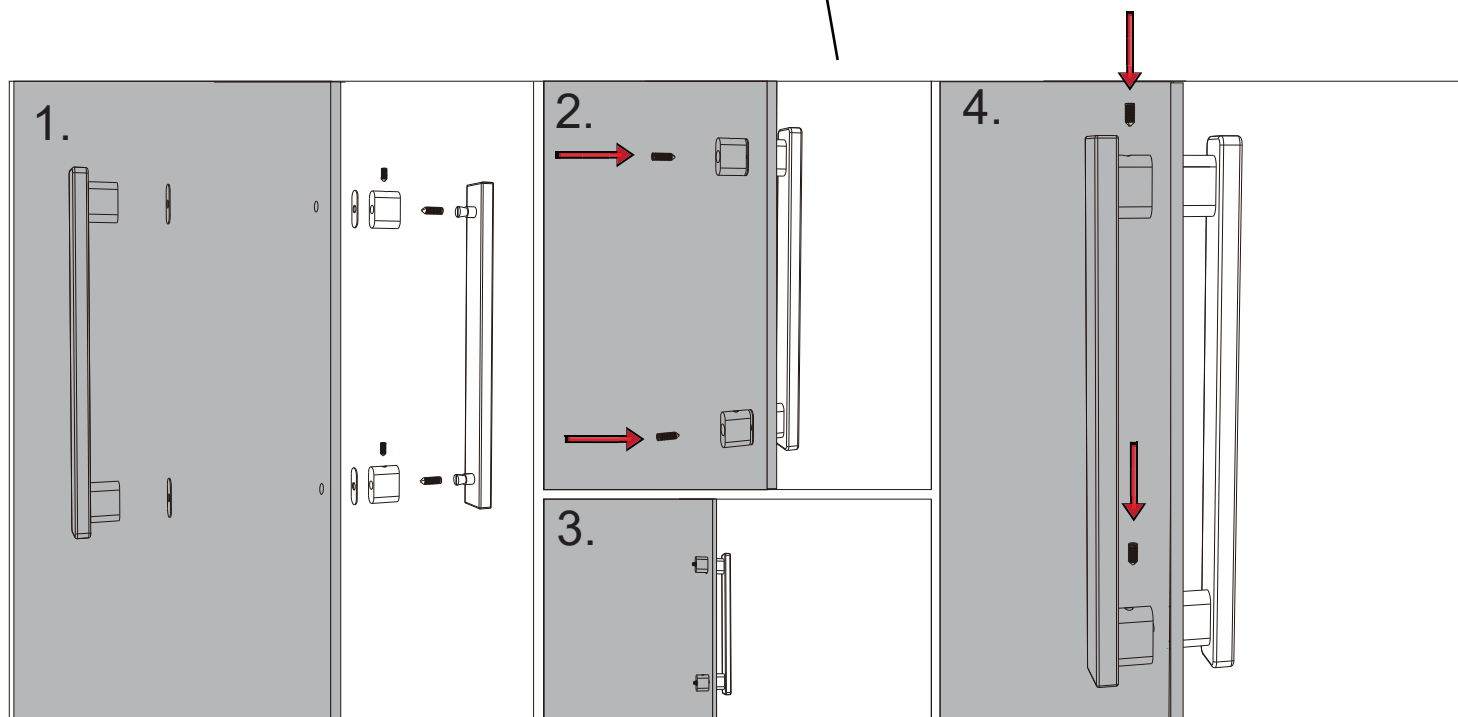
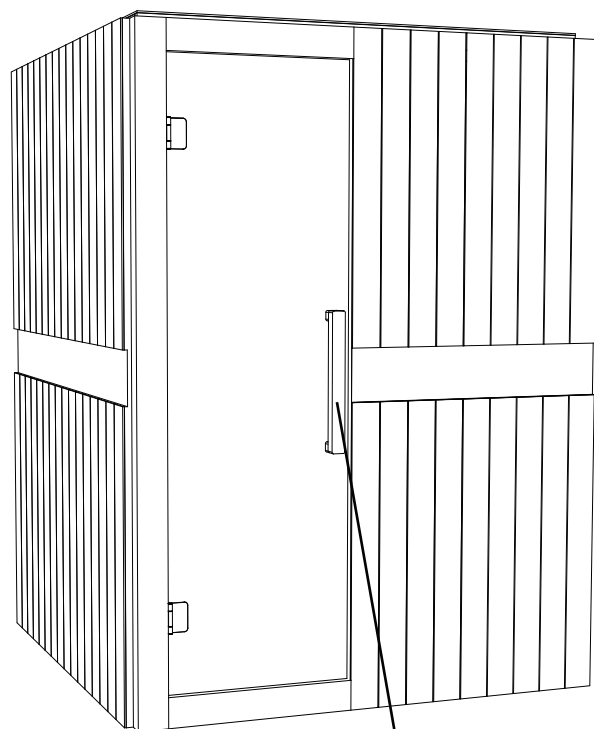

Operation

1. Precautions

- a. Check all the circuitry and the plug meet all requirements.
- b. Set the temperature and time to a comfortable level.
- c. Drink a cup of water before the sauna session.
- d. After 2 hours of continuous use, shut the sauna down for one hour.
- e. To avoid burns, do not touch the heating element.
- f. **WARNING:**Covering the heater or infrared emitter causes fire risk!

2. Operation

- a. Plug the sauna into a outlet which is stated in nameplate. Do not share the outlet with any other appliances.

Sauna should be unplugged when not in use.

- b. Press the lamp switch to turn the interior light on and off.
- c. After your sauna session, turn off, and unplug the power cable.
- d. See the user manual of sauna stove to use it.

Warnings

1. Safety precautions
 - a. To avoid fire, do not dry clothes or leave any towels in the sauna.
 - b. To prevent burns or electric shocks, do not touch or use metal tools on the net cover of the sauna heater elements.
 - c. While in the sauna, do not touch the light bulb. If the bulb needs to be changed, switch it off and wait until the sauna is shut off and the bulb is cool.
 - d. Do not use the traditional sauna if you have any of the following conditions:
 1. Open wounds
 2. Eye diseases
 3. Sever sunburns
 4. Elderly & weak people, especially those suffering from a disease, pregnant women and infants are prohibited. Children over the age of 6 years may use the sauna under the supervision of adults.
 5. If suffering from a disease directly related to temperature, seek the advice of a doctor before using.
 6. Do not place pets in the sauna.
 7. Do not use the sauna if you are under the effects of alcohol.

Trouble Shooting:

	problem	possible reason	countermeasure
1	Indicator light for power supply not working	The connector is not connected properly	Check the connector or replace a new one
		No power supply input	Check the circuitry
		Indicator light is broken	replace the outer controller
2	Sauna stove is not heating up	The heater is broken	Replace with a new one Of the same specifications
		The wire junction or the heater's wire is loosen	Check and make them tight
3	Odor from the sauna	The circuit's problems	1) there is eye winker around, remove it 2) parts on the circuit is broken
4	Light bulb is not working	Light bulb is burned out	Replace the light bulb
		Lamp holder is broken	Replace the lamp holder